

Product Data

Driwall™ Weep Screed

Description

Driwall™ Weep Screed is used as a flashing and weep when paired with a weather-resistant barrier, or building paper and Driwall™ Rainscreen.

It provides a clean termination for stucco, manufactured stone and thin natural stone at the bottom of the wall.

The unique “V”-shape allows migration of moisture down the screed and away from the wall.

This product is required by all major building codes and the International Building Code at the bottom of all framed walls.

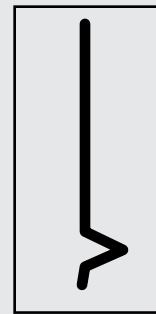

Profile view
of Driwall™ Weep
Screed

Features and Benefits

3 ½-Inch (89-mm) nailing and flashing flange

Color: gray

¾-Inch (19-mm) “V”-shaped drip edge

5-foot lengths

PVC material meets ASTM standards D1784, C1063 and D4216-99

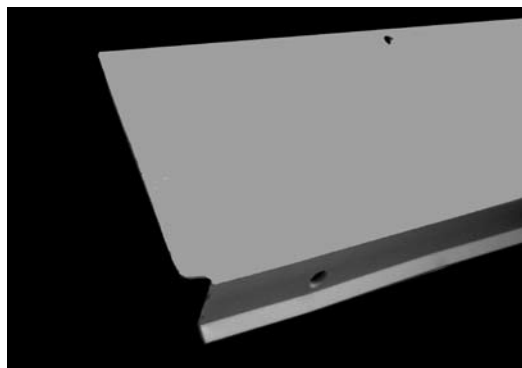

Installation Instructions

Please see back of sheet

Installation Instructions

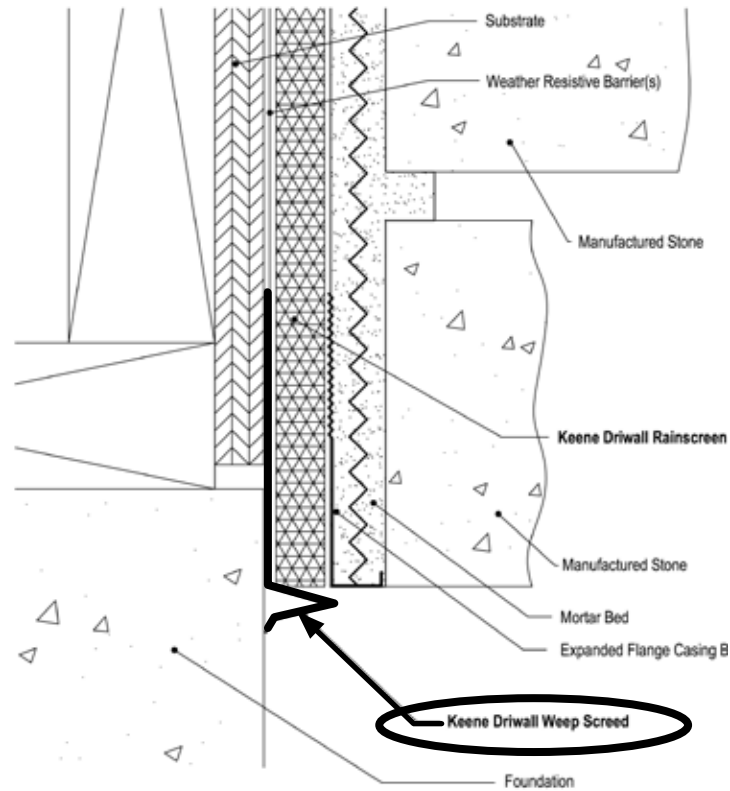

- ✓ Install Driwall™ Weep Screenshot on frame construction where stucco, manufactured stone or thin natural stone and foundation wall meet
- ✓ Shall be used where specified by the architect and installed per industry standards and according to local code
- ✓ Caulk all butt joints, intersections and ends

LIMITED WARRANTY: Keene Building Products, Inc. warrants to the initial purchaser only that the goods sold hereunder will be free from defects in material and workmanship and, except as otherwise set forth herein, will conform to the specifications provided. If any failure to meet this warranty appears within one year from the date of shipment of the goods, on the condition that Keene Building Products, Inc. will correct any such failure by either replacing or repairing any defective goods, at Keene Building Products, Inc.'s option.

The preceding paragraph sets forth the exclusive remedy for all claims based on failure of or defect in the goods sold hereunder, whether such failure or defect arises before or during the warranty period and whether a claim, however instituted, is based on contract, indemnity, warranty, tort (including negligence), strict liability or otherwise. The forgoing warranty is exclusive and is in lieu of all other warranties whether written, oral, implied or statutory.



P.O. Box 241353
Mayfield Heights, OH 44124
Info@KeeneBuilding.com
www.KeeneBuilding.com

877 | 514 | 5336
P 440 | 605 | 1020
F 440 | 605 | 1120